

Automatic Waste Water Pump Station

Evamatic-Box N

Type Series Booklet

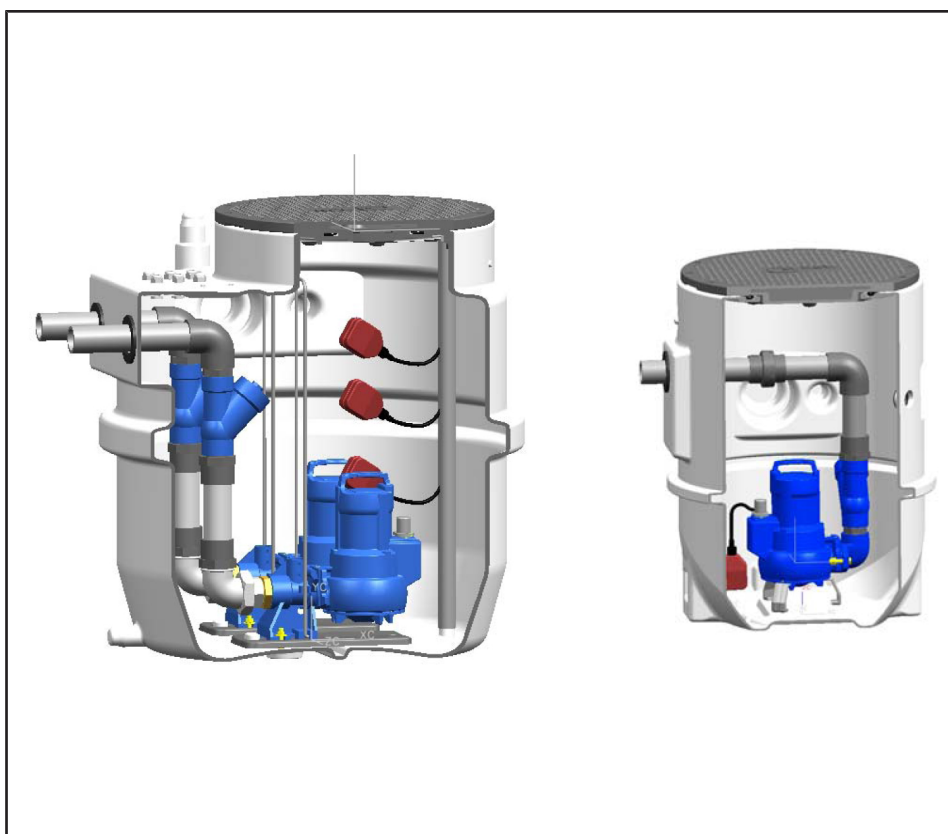

Legal information/Copyright

Type Series Booklet Evamatic-Box N

All rights reserved. The contents provided herein must neither be distributed, copied, reproduced, edited or processed for any other purpose, nor otherwise transmitted, published or made available to a third party without the manufacturer's express written consent.

Subject to technical modification without prior notice.

© KSB S.A.S, Sequedin/Lille, France 23/10/2020

Contents

Waste Water Pump Station.....	4
Pump Station for Domestic Waste Water.....	4
Evamatic-Box N.....	4
Main applications.....	4
Fluids handled	4
Operating data.....	4
Design details.....	4
Designation	5
Configuration and function	6
Materials.....	7
Product benefits	7
Selection information	7
Overview of product features / selection tables	7
Technical data	8
Characteristic curves.....	11
Dimensions	13
Scope of supply	15
Accessories.....	16
General assembly drawings.....	19

Waste Water Pump Station

Pump Station for Domestic Waste Water

Evamatic-Box N

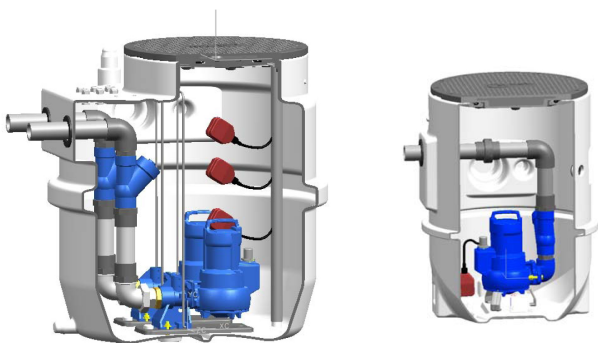

Main applications

- Waste water disposal
- Automatic drainage of buildings and premises below the flood level
- Drainage systems
- Rainwater harvesting

i The pump is not approved for use in countries stipulating explosion-proof units for handling waste water containing faeces.

Fluids handled

- Waste water with faeces¹⁾
- Solid particles with a particle size of 45 to 60 mm
- Slightly contaminated water
- Waste water

Operating data

Operating properties

Characteristic		Value
Flow rate	Q [m³/h]	≤ 40
	Q [l/s]	≤ 11
Head	H [m]	≤ 21
Fluid temperature	T [°C]	≤ +40 (continuous duty)
		≤ +70 (short-time duty, ≤ 5 minutes)

Design details

Design

- Tank made of impact-resistant plastic for above-floor installation/ underfloor installation
- Single-pump unit or dual-pump unit
- Tank volume 200 or 500 litres
- To EN 12050-2
- Closed with odour-proof cover²⁾
- Lift check valve integrated in the supplied piping

Installation

Evamatic-Box N 200 l:

- Stationary dry installation
- Wet-installed stationary model
- Transportable model for dry installation
- Wet-installed transportable model

Evamatic-Box N 500 l:

- Stationary dry installation
- Wet-installed stationary model

Drive

- Single-phase AC motor, 50 Hz, 230 V, with integrated temperature switch
- Three-phase asynchronous motor, 50 Hz, 400 V, DOL starting
- Enclosure IP68 (permanently submerged) to EN 60529 / IEC 529
- Thermal class F

Shaft seal

Drive end:

- Shaft seal ring

Pump-end:

- 1 bi-rotational mechanical seal with oil reservoir filled with environmentally friendly oil

Impeller type

- Various application-oriented impeller types (⇒ Page 7)

Bearings

- Grease-packed bearings sealed for life

Automation

- KSB recommends the use of a LevelControl Basic 2 control unit. (Electrical accessories optionally available.)

Connections

- Inlet side DN 50/DN 70/DN 100/DN 150 for cutting open
- Discharge outlet DN 50/DN 65 for cutting open if supplied as an assembly kit
- Drain DN 40 for cutting open

¹ Permitted for waste water without faeces only, according to EN 12050

² The tanks are absolutely odour-proof. They have been successfully leak-tested at a test pressure of 0.5 bar (in accordance with DIN EN 12050-1).

Designation

Example: Evamatic-Box N 2 501 E P M

Designation key

Code	Description	
Evamatic-Box N	Type series	
2	Number of pumps	
	1	1 pump
	2	2 pumps
501	Pump type	
	32	Amarex NS 32
	5..	Ama-Porter
	6..	Ama-Porter
E	Motor version	
	E	Single-phase AC motor
	D	Three-phase asynchronous motor
_ ³⁾	Start capacitor	
	_ ³⁾	Without start capacitor
	B	With start capacitor
P	Installation type	
	P	Transportable, mounted on 3 pump feet
	S	Stationary, mounted on flanged bend
M	As-delivered condition	
	M	Collecting tank fully assembled
	K	Collecting tank as assembly kit

³ Blank

Configuration and function

Evamatic-Box N 200 I

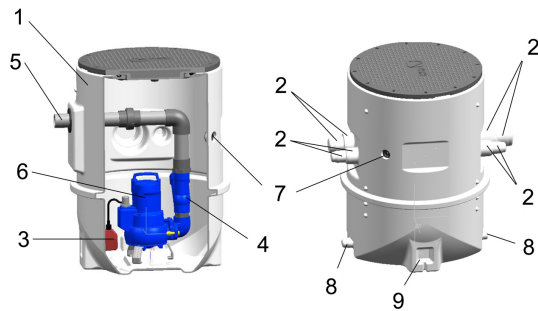

Fig. 1: Illustration of the waste water pump station, 200 l

1	Collecting tank	6	Submersible motor pump
2	Nozzles for inlet or venting	7	Cable entry for power cable
3	Float switch	8	Drainage nozzle
4	Ball check valve	9	Floor mount
5	Discharge line		

Design

The pump station consists of a stable collecting tank (1) with integrated submersible motor pump (6), an inlet nozzle (2) and a vent nozzle (2) (8 options available for selection) as well as a discharge line (5).

Function

The fluid handled flows into the pump station through the inlet nozzle (2) and is collected in a gas-, odour- and water-tight tank (1) made of polyethylene. As soon as the float switch (3) detects a defined fill level, the submersible motor pump (6) is started up automatically. The fluid handled is pumped off through the discharge line to a level above the flood level and into the public sewer. As soon as the float switch (3) detects a defined minimum fill level, the submersible motor pump (6) is stopped automatically.

Evamatic-Box N 500 I

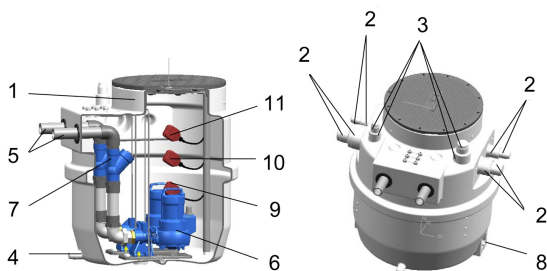

Fig. 2: Illustration of the waste water pump station, 500 l

1	Collecting tank	7	Ball check valves
2	Horizontal nozzles for inlet or venting	8	Floor mount
3	Vertical nozzles for inlet or venting	9	Float switch pump 1 ON and pump 1 and 2 OFF
4	Drainage nozzle	10	Float switch pump 2 ON
5	Discharge lines	11	Float switch for alarm
6	Submersible motor pumps		

Design



The pump station consists of a stable collecting tank (1) with two integrated submersible motor pumps (6), a horizontal (2) or vertical (3) inlet nozzle, a horizontal (2) or vertical (3) vent nozzle (12 options available for selection) as well as two discharge lines (5).

Function

The fluid handled flows into the pump station through the inlet nozzle (2) or (3) and is collected in a gas-, odour- and water-tight tank (1) made of polyethylene. As soon as the float switch (9) detects a defined fill level, the first submersible motor pump (6) is started up automatically. The fluid handled is pumped off through the discharge line to a level above the flood level and into the public sewer. If the float switch (10) detects a rising fill level while one pump is in operation, the second submersible motor pump (6) is started up automatically. As soon as the float switch (9) detects a defined minimum fill level, both pumps (6) are stopped automatically. The alarm float switch (11) needs to be connected to an alarm switchgear for acoustic or visual alarm (optional alarm switchgear can be supplied by KSB).

Overview of product features / selection tables

Impellers

	Free-flow impeller (impeller type F)	Suitable for the following fluids: fluids containing solids and stringy material as well as fluids with entrapped air or entrapped gas
	Impeller with cutter (impeller type S)	Suitable for the following fluids: faeces, domestic sewage and waste water containing long fibres

Materials

- Single-piece water-proof tank made of polyethylene
- Pipe made of PVC

Product benefits

- Control unit enables automatic pump operation
- Easy installation, above-floor or underfloor
- Pump can easily be lifted out of and lowered into the tank through the large access opening (tank cover).
- Numerous connection options provide a high degree of flexibility.
- Easy access to float switches fastened to a removable rod, patented system (Evamatic-Box N 500 I)
- Non-clogging hydraulic system due to free-flow impeller/cutter

Selection information

Lightning protection

- Electrical installations must be protected against overvoltage (compulsory since 14 December 2018) (see DIN VDE 0100-443 (IEC60364-4-44:2007/A1:2015, modified) and DIN VDE 0100-534 (IEC 60364-5-53:2001/A2:2015, modified). Whenever modifications are made to existing installations, retrofitting a surge protective device (SPD) in accordance with VDE is mandatory.
- A maximum cable length of 10 metres should not be exceeded between the surge protective device (usually type 1, internal lightning protection) installed at the service entrance and the equipment to be protected. For longer cables, additional surge protective devices (type 2) must be provided in the sub-distribution board upstream of the equipment to be protected or directly in the equipment itself.
- The associated lightning protection concept must be provided by the operator or by a suitable provider commissioned by the operator. Surge protective devices can be offered for the control units on request.

Technical data

Evamatic-Box N: Transportable version as assembly kit, 200 l

Overview of technical data

Size	Free-flow impeller	Impeller with cutter	Free passage [mm]	P ₁	I _N 1~230 V	I _N 3~400 V	Mat. No.	[kg]
				[kW]	[A]	[A]		
1500 E-P-K	X	-	45	0,55	5,0	-	39023380	54
1501 E-P-K	X	-	45	0,75	6,0	-	39023381	54
1502 E-P-K	X	-	45	1,10	8,2	-	39023382	54
1503 E-P-K	X	-	45	1,10	8,2	-	39023383	54
1601 E-P-K	X	-	60	0,75	6,0	-	39023384	64
1602 E-P-K	X	-	60	1,10	8,2	-	39023385	64
1603 E-P-K	X	-	60	1,10	8,2	-	39023386	64
1545 EB-P-K	-	X	-	1,10	8,2	-	39023387	57
2545 D-S-M	-	X	-	1,50	-	3,5	39023641	114

Evamatic-Box N: Stationary version as assembly kit, 200 l

Overview of technical data

Size	Free-flow impeller	Impeller with cutter	Free passage [mm]	P ₁	I _N 1~230 V	I _N 3~400 V	Mat. No.	[kg]
				[kW]	[A]	[A]		
1500 E-S-K	X	-	45	0,55	5,0	-	39023388	70
1501 E-S-K	X	-	45	0,75	6,0	-	39023389	70
1502 E-S-K	X	-	45	1,10	8,2	-	39023390	70
1503 E-S-K	X	-	45	1,10	8,2	-	39023391	70
1601 E-S-K	X	-	60	0,75	6,0	-	39023392	83
1602 E-S-K	X	-	60	1,10	8,2	-	39023393	83
1603 E-S-K	X	-	60	1,10	8,2	-	39023394	83
1545 EB-S-K	-	X	-	1,10	8,2	-	39023395	73

Evamatic-Box N: Stationary version fully assembled, 200 l

Overview of technical data

Size	Free-flow impeller	Impeller with cutter	Free passage [mm]	P ₁	I _N 1~230 V	I _N 3~400 V	Mat. No.	[kg]
				[kW]	[A]	[A]		
1500 E-S-M	X	-	45	0,55	5,0	-	39023561	70
1501 E-S-M	X	-	45	0,75	6,0	-	39023541	70
1502 E-S-M	X	-	45	1,10	8,2	-	39023542	70
1503 E-S-M	X	-	45	1,10	8,2	-	39023632	70
1601 E-S-M	X	-	60	0,75	6,0	-	39023598	83
1602 E-S-M	X	-	60	1,10	8,2	-	39023633	83
1603 E-S-M	X	-	60	1,10	8,2	-	39023634	83
1545 EB-S-M	-	X	-	1,10	8,2	-	39023635	73
132U D-S-M	-	X	6	1,50	-	3,4	39023840	70

Evamatic-Box N: Stationary version as assembly kit, 500 l

Overview of technical data

Size	Free-flow impeller	Impeller with cutter	Free passage	P ₁	I _N 1 ~ 230 V	I _N 3 ~ 400 V	Mat. No.	[kg]
			[mm]	[kW]	[A]	[A]		
2500 E-S-K	X	-	45	0,55	5,0	-	39023396	110
2501 E-S-K	X	-	45	0,75	6,0	-	39023397	110
2502 E-S-K	X	-	45	1,10	8,2	-	39023398	110
2503 E-S-K	X	-	45	1,10	8,2	-	39023399	110
2601 E-S-K	X	-	60	0,75	6,0	-	39023400	122
2602 E-S-K	X	-	60	1,10	8,2	-	39023401	122
2603 E-S-K	X	-	60	1,10	8,2	-	39023402	122
2500 D-S-K	X	-	45	0,55	-	2,3	39023404	110
2501 D-S-K	X	-	45	0,75	-	2,8	39023405	110
2502 D-S-K	X	-	45	1,10	-	3,0	39023406	110
2503 D-S-K	X	-	60	1,50	-	3,5	39023407	110
2601 D-S-K	X	-	60	0,75	-	2,8	39023408	122
2602 D-S-K	X	-	60	1,10	-	3,0	39023409	122
2603 D-S-K	X	-	60	1,50	-	3,5	39023410	122
2545 EB-S-K	-	X	-	1,10	8,2	-	39023403	117
2545 D-S-K	-	X	-	1,50	-	3,5	39023411	114

Evamatic-Box N: Stationary version fully assembled, 500 l

Overview of technical data

Size	Free-flow impeller	Impeller with cutter	Free passage	P ₁	I _N 1 ~ 230 V	I _N 3 ~ 400 V	Mat. No.	[kg]
			[mm]	[kW]	[A]	[A]		
2500 E-S-M	X	-	45	0,55	5,0	-	39023595	110
2501 E-S-M	X	-	45	0,75	6,0	-	39023544	110
2502 E-S-M	X	-	45	1,10	8,2	-	39023545	110
2503 E-S-M	X	-	45	1,10	8,2	-	39023636	110
2601 E-S-M	X	-	60	0,75	6,0	-	39023600	122
2602 E-S-M	X	-	60	1,10	8,2	-	39023637	122
2603 E-S-M	X	-	60	1,10	8,2	-	39023638	122
2500 D-S-M	X	-	45	0,55	-	2,3	39023596	110
2501 D-S-M	X	-	45	0,75	-	2,8	39023546	110
2502 D-S-M	X	-	45	1,10	-	3,0	39023547	110
2503 D-S-M	X	-	45	1,50	-	3,5	39023639	110
2601 D-S-M	X	-	60	0,75	-	2,8	39023601	4
2602 D-S-M	X	-	60	1,10	-	3	39023642	122
2603 D-S-M	X	-	60	1,50	-	3,5	39023643	122
2545 EB-S-M	-	X	-	1,10	8,2	-	39023640	117
2545 D-S-M	-	X	-	1,50	-	3,5	39023641	114

Characteristic curves

Evamatic-Box N; n = 2900 rpm; F impeller

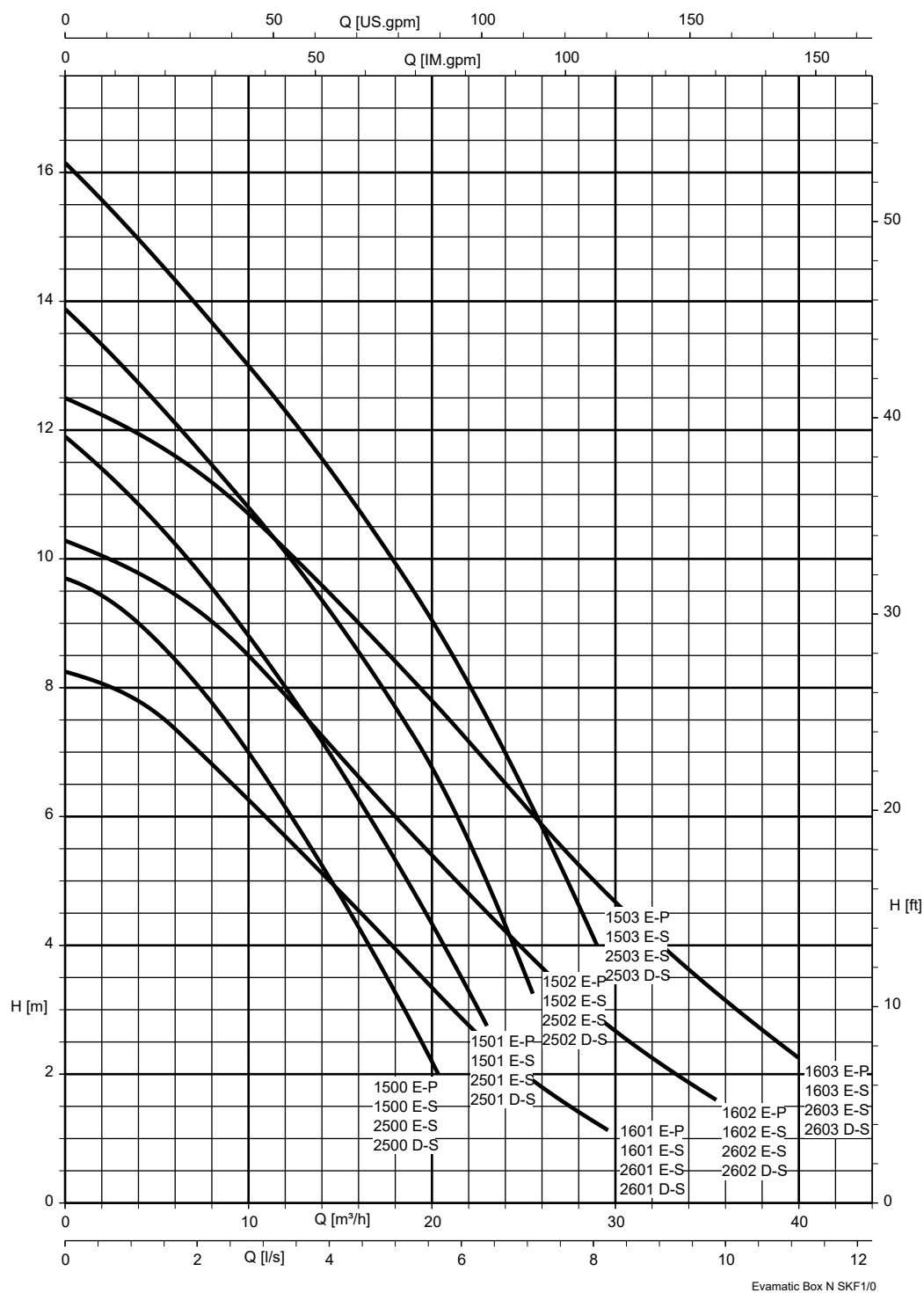

Evamatic-Box N; n = 2900 rpm; S impeller

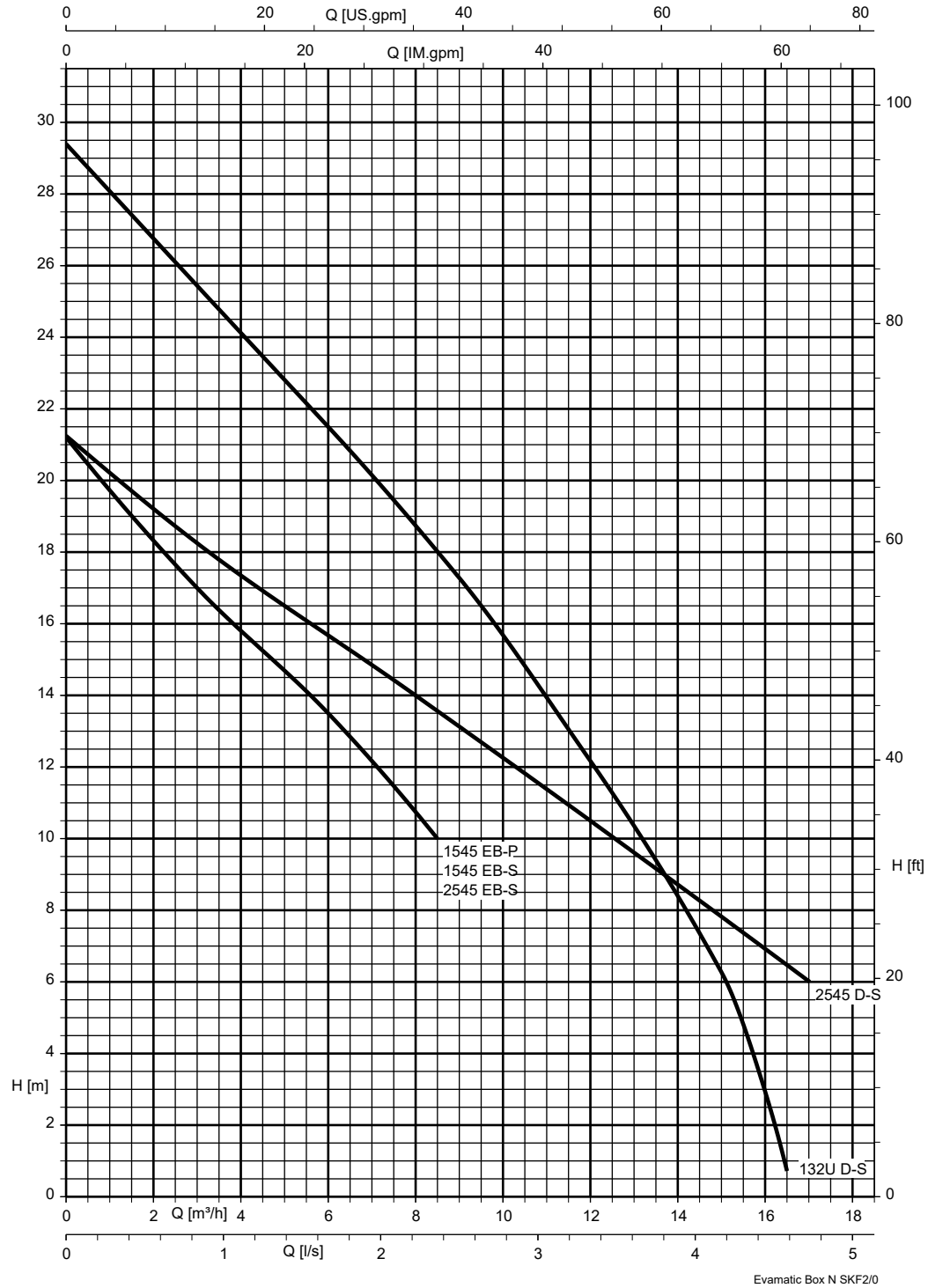

Dimensions

Evamatic-Box N 200 I

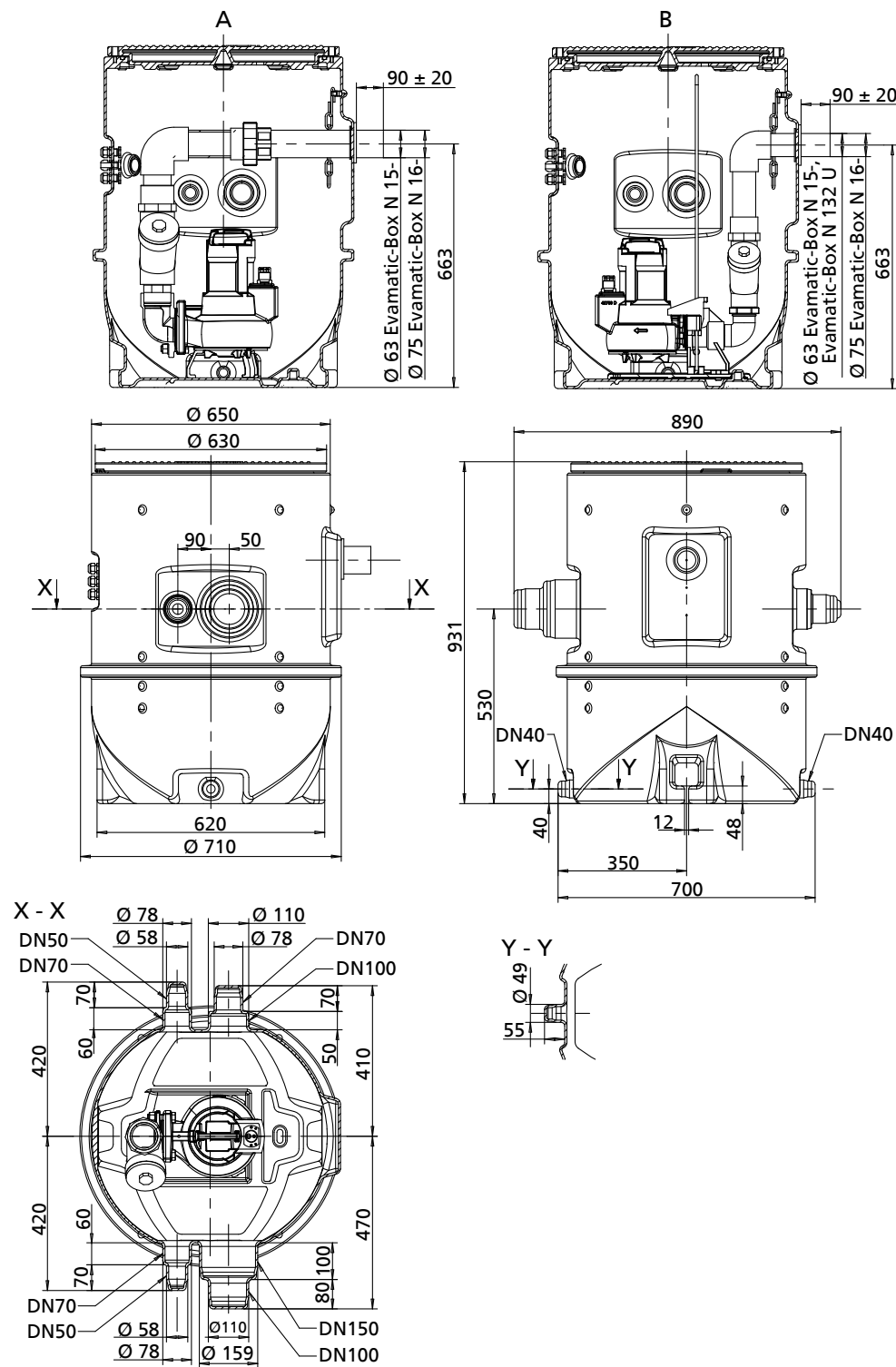

Fig. 3: Outline drawing of Evamatic-Box N 200 I

A	Transportable version	B	Stationary version
---	-----------------------	---	--------------------

Evamatic-Box N 500 I

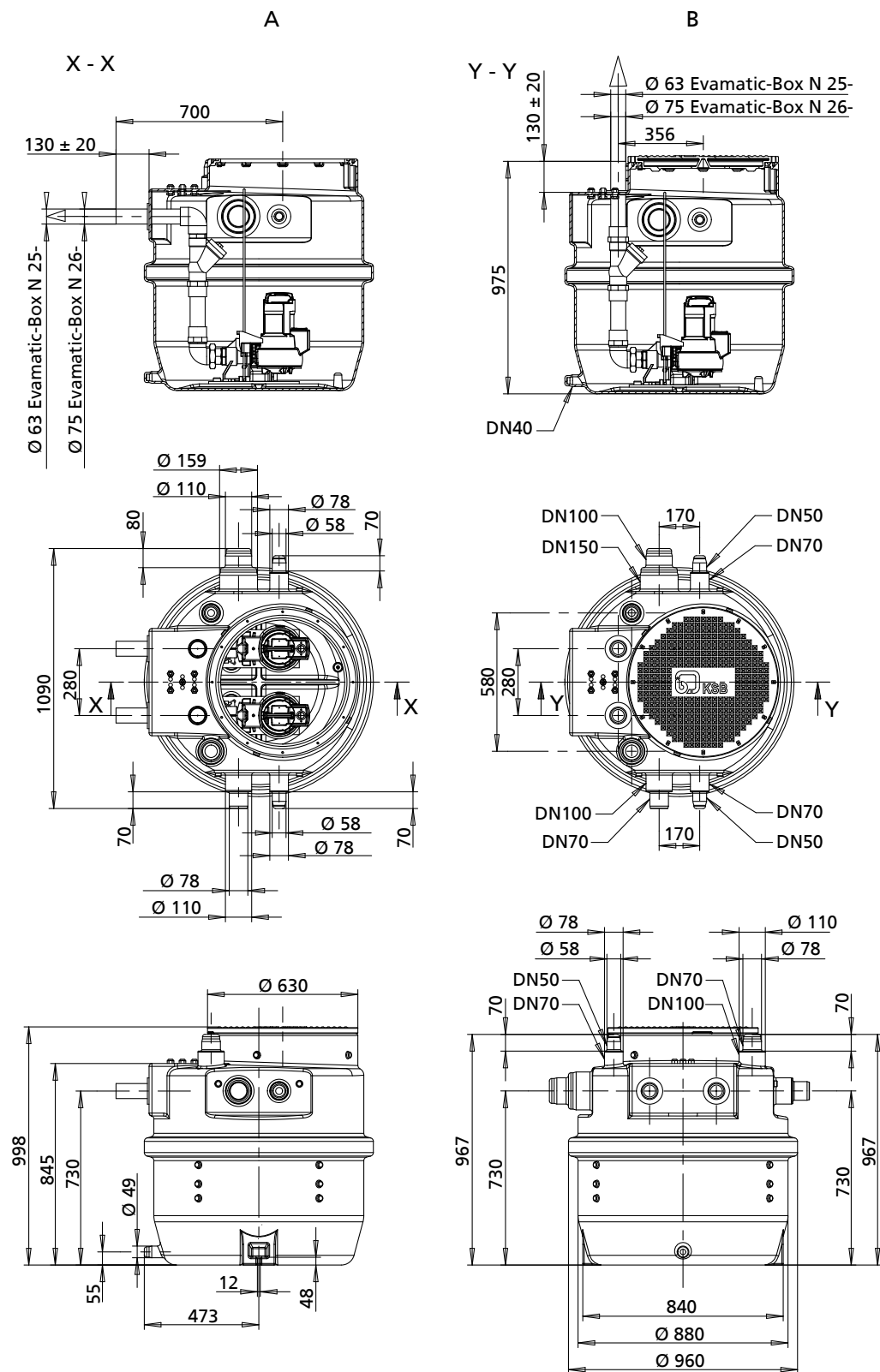

Fig. 4: Outline drawing Evamatic-Box N 500 I, stationary installation

A	Discharge line outlet, horizontal	B	Discharge line outlet, vertical
---	-----------------------------------	---	---------------------------------

Scope of supply

Depending on the model, the following items are included in the scope of supply:

Evamatic-Box N 200 I with transportable pump version (supplied as assembly kit)

- 200-litre tank, access cover with screws and sealing element
- Complete discharge line with ball check valve and sealing element
- Ama-Porter submersible motor pump with single-phase motor and float switch
- Lifting chain made of stainless steel 1.4401
- Cable entry for power cable
- Hook made of stainless steel 1.4571

Evamatic-Box N 200 I with stationary pump version (supplied as assembly kit)

- 200-litre tank, access cover with screws and sealing element
- Complete foot with cast iron baseplate, pump claw, guide hoop and bolts/screws
- Complete horizontal discharge line, DN 50/DN 65, with ball check valve and sealing element
- Ama-Porter submersible motor pump with single-phase motor and float switch
- Lifting chain made of stainless steel 1.4401
- Cable entry for power cable
- Hook made of stainless steel 1.4571

Evamatic-Box N 200 I with stationary pump version (supplied fully assembled)

- Baseplate with foot, guide hoop and discharge line, fully assembled
- Ama-Porter pump with single-phase motor and float switch, or Amarex N S 32 pump with three-phase motor and float switch, foot-mounted
- Power cable
- Cable grommet or PG cable gland
- Lifting chain made of stainless steel 1.4401
- The cover is mounted, temporarily fastened with 2 screws; the remaining 10 screws are in a bag inside the collecting tank.
- 8 nozzle options for inlet and venting, from DN 50 to DN 150, for cutting open
- DN 40 drain nozzle, for cutting open

Evamatic-Box N 500 I with horizontal or vertical discharge outlet and stationary pump versions (supplied as assembly kit)

- 500-litre tank, access cover with screws and sealing element
- Two complete feet with cast iron baseplates, pump claws, guide hoops and bolts/screws
- Two complete discharge lines with ball check valve and sealing element (the discharge line supplied is suitable for horizontal or vertical discharge)
- 2 Ama-Porter submersible motor pumps with single-phase or three-phase motor
- Two lifting chains made of stainless steel 1.4401

- Five PG cable glands for routing the two power cables of the pumps and the three float switch cables through the tank wall
- Three float switches fastened to a removable rod for installation in the tank. The arrangement of the float switches is predefined in the factory.
- One hook made of stainless steel 1.4571 (per pump)









Evamatic-Box N 500 I with horizontal discharge outlet and stationary pump versions (supplied fully assembled)

- Baseplates with feet, guide hoops and horizontal discharge lines, fully assembled
- Pumps mounted on feet
- Power cables
- Rod for float switches
- Cable clips
- PG cable glands
- Lifting chains
- The cover is mounted, temporarily fastened with 2 screws; the remaining 10 screws are in a bag inside the collecting tank.
- 12 nozzle options for inlet and venting, from DN 50 to DN 150, for cutting open
- DN 40 drain nozzle, for cutting open

Accessories

Pump station accessories

Overview of pump station accessories



Item	Description	Connection / length	Mat. No.	[kg]
P14 	Hand diaphragm pump	Rp 1 1/2	00520485	12
- 	Socket gate valve PVC	DN 50 DN 65	39017886 39018149	0 2,1
- 	Cable connector, IP68, for fastening at the cover, for connecting the pumps/float switches inside the tank (1 cable connector per cable) For Ama-Porter F with single-phase AC motor / For float switches	-	39023444	0,052
-	Cable connector, IP68, for fastening at the cover, for connecting the pumps/float switches inside the tank (1 cable connector per cable) For Ama-Porter S with single-phase AC motor/Ama-Porter with three-phase motor	-	39023445	0,08
- 	Level-adjusting piece	300 mm	39023481	5,751
- ⁴⁾ 	8 noise reduction pads made of natural rubber, Self-adhesive, For fitting on the tank floor	-	18078943	0,02
p9 ⁴⁾ 	Pipe adapter, EPDM/stainless steel, PN 05 for connecting inlet and vent lines of different outside diameters	DN 70 for outside pipe diameter 53 - 63 mm	01313530	0,263
p9 ⁴⁾ 	Pipe adapter, EPDM/stainless steel, PN 05 for connecting inlet and vent lines of different outside diameters	DN 100 for outside pipe diameter 53 - 63 mm	39023452	0,5
p9 ⁴⁾ 	Pipe adapter, EPDM/stainless steel, PN 05 for connecting inlet and vent lines of different outside diameters	DN 100 for outside pipe diameter 75 - 89 mm	39023453	0,5

⁴⁾ Not valid for France.

Control units and switchgears, 200 l

 Not valid for France.

AS 0 / AS 2 / AS 4

Item	Description	Mat. No.	[kg]
E50	Alarm switchgear AS 0  with circuit breaker, acoustic signal transmitter with 85 dB(A), green equipment-on lamp Plastic housing, IP20, H x W x D = 140 x 80 x 57 [mm]. Use float switch, F1 leakage sensor (item E64), M1 alarm contactor or signal relay of control unit as contactor.	29128401	0,5
E51	Alarm switchgear AS 2  With circuit breaker, acoustic signalling device with 85 dB(A), green equipment-on lamp, volt-free contact for hook-up to a control station Plastic housing, IP20, H x W x D = 140 x 80 x 57 [mm]. Use float switch, F1 leakage sensor (item E64) or signal relay of control unit as contactor.	29128422	0,5
E52	Alarm switchgear AS 4  with circuit breaker, acoustic signal transmitter with 85 dB(A), green equipment-on lamp, volt-free contact for hook-up to a control station, self-charging power supply unit for 5 hours of operation in the event of a power failure Plastic housing, IP20, H x W x D = 140 x 80 x 57 [mm]. Use float switch (E60), F1 leakage sensor (item E64) or signal relay of control unit as contactor.	29128442	0,5

Accessories for control units and switchgears, 200 l

 Not valid for France.

Overview of accessories for control units and switchgears, 200 l

Item	Description	1~230 V		Mat. No.	[kg]
		1500 E 1501 E 1601 E	1502 E 1503 E 1602 E 1603 E 1545 EB		
E 60 	Float switch with free cable end (NO contact) 10 m	X	X	39023446	1,5

Control units and switchgears for France, 200 l

 Only valid for France.

Overview of control units and switchgears for France, 200 l

Item	Description	Type	Current Min. / Max.	3~400 V	Mat. No.	[kg]
			[A]	132U-D		
E30, E31 	LevelControl Basic 2 control unit for single-pump station, IP 54 to NF C 15-100 DOL starting, With manual-0-automatic selector switch, Indicator lamps and control panel, High water alert, Integrated alarm buzzer, 85 dB(A), operating hours counter/meter start-stop cycle counter per pump Voltage measurement, phase monitoring, Volt-free contact for general fault message Optional mains-independent alarm via rechargeable battery For float switch or 4 - 20 mA sensor, with master switch, 400 x 278 x 120 mm	BC1 400 DFNO 40 02	2,5 - 4,0	X	19073878	4,5

Control units and switchgears, 500 I

 Not valid for France.

Overview of control units and switchgears, 500 I

Item	Description	Type	Current Min. / Max.	1~230 V		3~400 V		Mat. No.	[kg]
			[A]	2500 E 2501 E 2601 E	2502 E 2503 E 2602 E 2603 E 2545 EB	2500 D	2501 D 2502 D 2503 D 2601 D 2602 D 2603 D 2545 D		
	LevelControl Basic 2 control unit for dual-pump station, IP54 For float switch or 4 - 20 mA sensor, optionally with master switch, 400 x 281 x 135 mm	BC2 230 ^{DFNO} 100	≤ 10,0	X	X	-	-	19073774	4,7
		BC2 400 ^{DFNO} 025	1,6 - 2,5	-	-	X	-	19073776	4,7
		BC2 400 ^{DFNO} 040	2,5 - 4,0	-	-	-	X	19073777	4,7

Control units and switchgears for France, 500 I

 Only valid for France.

Overview of control units and switchgears for France, 500 I

Item	Description	Type	Current Min. / Max.	1~230 V		3~400 V		Mat. No.	[kg]
			[A]	2500 E 2501 E 2601 E	2502 E 2503 E 2602 E 2603 E 2545 EB	2500 D	2501 D 2502 D 2503 D 2601 D 2602 D 2603 D 2545 D		
	LevelControl Basic 2 control unit for dual-pump station, IP 54 To NF C 15-100 Peak load operation function DOL starting Indicator lamps, control panel, High water alert, Integrated alarm buzzer, 85 dB(A), Operating hours counter / counter for start-stop cycles per pump, Voltage measurement, phase monitoring, Volt-free contact for general fault message Optional mains-independent alarm via rechargeable battery, For float switch or 4 - 20 mA sensor, Master switch, 400 x 281 x 135	BC2 230 ^{DFNM} 063 02	4,0 - 6,3	X	-	-	-	19073884	4,7
		BC2 230 ^{DFNM} 100 02	6,3 - 10,0	-	X	-	-	19073885	4,7
		BC2 400 ^{DFNO} 025 02	1,6 - 2,5	-	-	X	-	19073887	4,7
		BC2 400 ^{DFNO} 040 02	2,5 - 4,0	-	-	-	X	19073888	4,7

General assembly drawings

Evamatic-Box N 200 I, transportable version (with Ama-Porter)

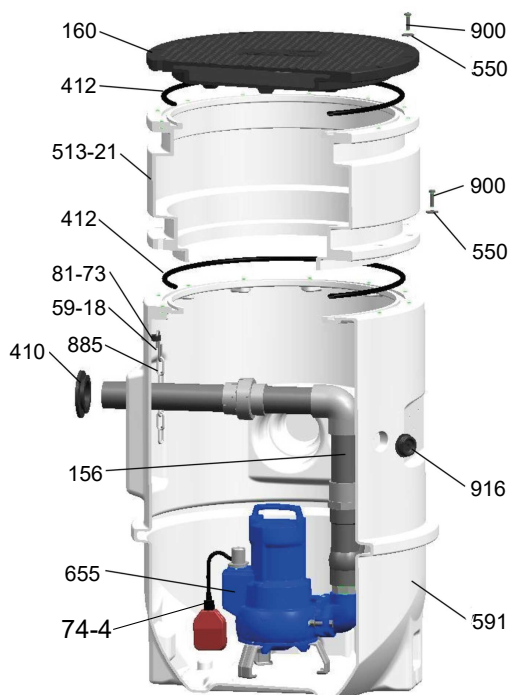

Fig. 5: Exploded view of the transportable version

Part No.	Description	Part No.	Description
156	Discharge nozzle	591	Collecting tank
160	Cover	655	Pump
410	Profile seal	74-4	Float switch
412	O-ring	81-73	Cable support
513-21	Level-adjusting piece + 1 x O-ring 412 (optional)	885	Chain
550	Disc	900	Bolt/screw
59-18	Hook	916	Cable grommet

Evamatic-Box N 200 I, stationary version (with Ama-Porter)

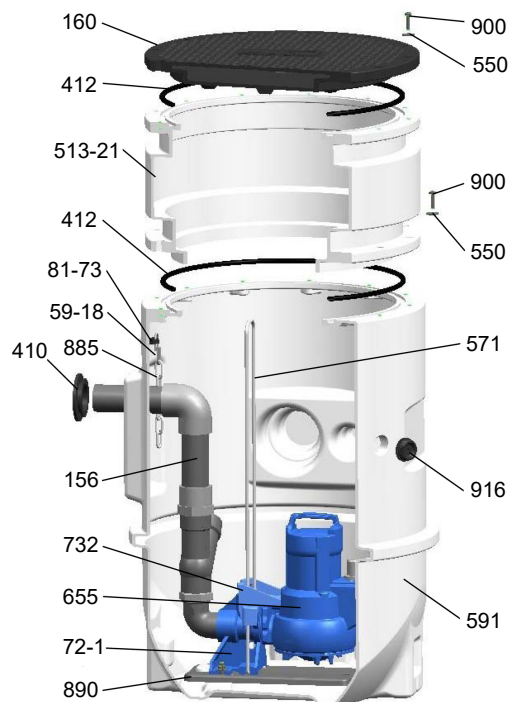

Fig. 6: Exploded view of the stationary version

Part No.	Description	Part No.	Description
156	Discharge nozzle	591	Collecting tank
160	Cover	655	Pump
410	Profile seal	72-1	Flanged bend
412	O-ring	81-73	Cable support
513-21	Level-adjusting piece + 1 x O-ring 412 (optional)	885	Chain
550	Disc	890	Baseplate
571	Guide hoop	900	Bolt/screw
59-18	Hook	916	Cable grommet

Evamatic-Box N 200 I, stationary version (with Amarex N S 32)

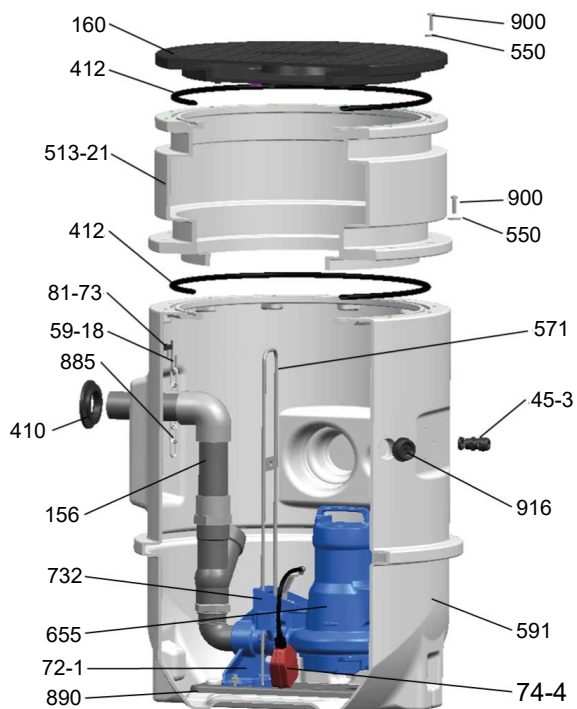

Fig. 7: Exploded view of the stationary version

Part No.	Description	Part No.	Description
156	Discharge nozzle	591	Collecting tank
160	Cover	655	Pump
45-3	Wall stuffing box	72-1	Flanged bend
410	Profile seal	74-4	Float switch
412	O-ring	81-73	Cable support
513-21	Level-adjusting piece + 1 x O-ring 412 (optional)	885	Chain
550	Disc	890	Baseplate
571	Guide hoop	900	Bolt/screw
59-18	Hook	916	Cable grommet

Evamatic-Box N 500 I

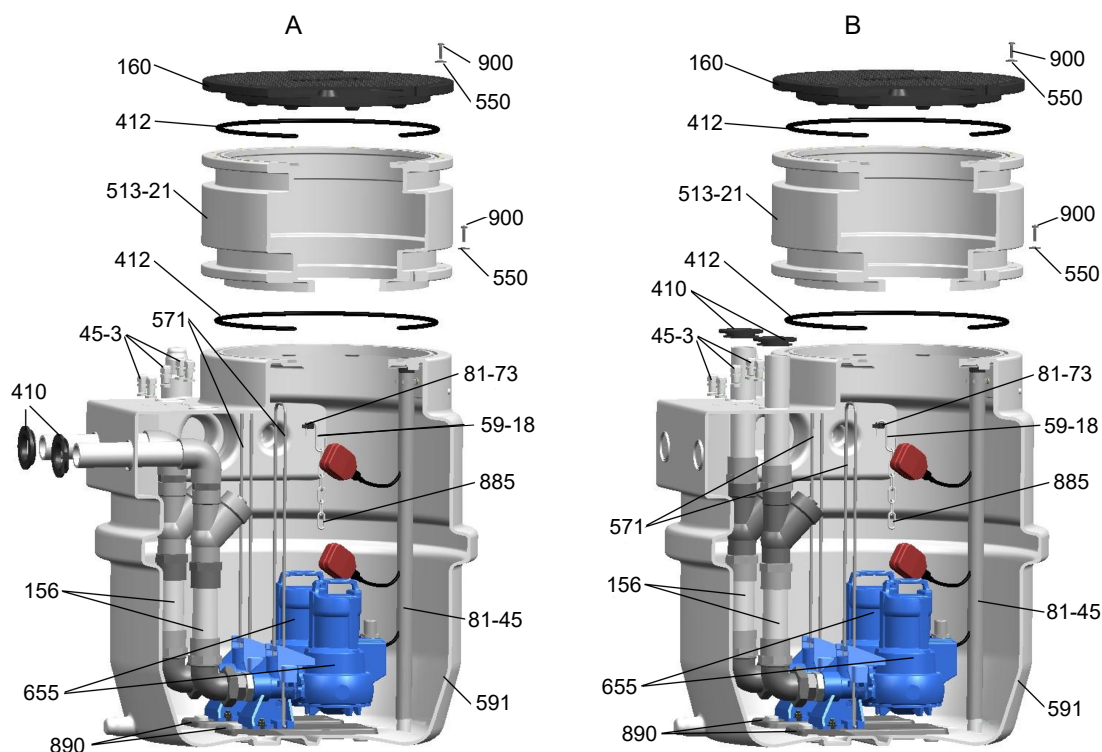

Fig. 8: Exploded view of versions with horizontal and vertical discharge outlet

Part No.	Description	Part No.	Description
A	Version with horizontal discharge outlet	59-18	Hook
B	Version with vertical discharge outlet	591	Collecting tank
156	Discharge nozzle	655	Pump
160	Cover	72-1	Flanged bend
410	Profile seal	81-45	Float switch
45-3	Wall stuffing box	81-73	Cable support
412	O-ring	885	Chain
513-21	Level-adjusting piece + 1 x O-ring 412 (optional)	890	Baseplate
550	Disc	900	Bolt/screw
571	Guide hoop		



KSB S.A.S.
4, allée des Barbanniers • 92635 Gennevilliers Cedex (France)
Tél. 09 69 39 29 79
www.ksb.fr